

BOARD OF TRUSTEES MEETINGS

September 15, 2023

8:15 a.m. Academic Affairs Committee
Student Affairs Committee
Business & Finance Committee
Executive Committee
Audit Committee
Audit Committee Executive Session (Non-Public)

No earlier than

9:45 a.m. Board Meeting

View archived video here:

<https://www.apsu.edu/board-of-trustees/archived-videos.php>

Academic affairs committee

LGI Fall Enrollment Day 14

Institution	Level	2022		2023		Percent Change	
		Headcount	FTE	Headcount	FTE	Headcount	FTE
MTSU	GR	2,648	1,419.08	2,515	1,401.33	-5.02%	-1.25%
MTSU	UG	17,442	14,657.80	17,672	14,777.87	1.32%	0.82%
MTSU	Total	20,090	16,076.88	20,187	16,179.20	0.48%	0.64%

APSU	GR	1,186	617	1,335	666.25	12.56%	7.98%
APSU	UG	7,814	5,826	8,314	6094.73	6.40%	4.61%
APSU	Total	9,000	6,443	9,649	6,761	7.21%	4.94%

UofM	GR	4,892	2,902.3	4,682	2,749.8	-4.29%	-5.25%
UofM	LW	317	381.6	283	340.8	-10.73%	-10.68%
UofM	UG	16,708	12,783.5	16,771	12,940.3	0.38%	1.23%
UofM	Total	21,917	16,067.4	21,736	16,030.9	-0.83%	-0.23%

ETSU	GR	10,554	9,304.1	2,478	1,679.1	-76.52%	-81.95%
ETSU	UG	2,422	1,681.1	10,642	9,414.8	339.39%	460.04%
ETSU	PHARM	210	210.0	170	170.0	-19.05%	-19.05%
ETSU	MED	299	299.0	300	300.0	0.33%	0.33%
ETSU	Total	13,485	11,494.2	13,590	11,564	0.78%	0.61%

TTU	GR	1,365	679.92	1,279	647.67	-6.30%	-4.74%
TTU	UG	8,537	7,919.94	8,838	8,105.93	3.53%	2.35%
TTU	Total	9,902	8,599.86	10,117	8,753.60	2.17%	1.79%

TSU	GR	1,540	930.00	1,364	858.83	-11.43%	-7.65%
TSU	UG	7,678	7,093.47	6,753	6,400.53	-12.05%	-9.77%
TSU	Total	9,218	8,023.47	8,117	7,259.36	-11.94%	-9.52%

Academic affairs committee

- Austin Peay State University intends to submit a Letter of Notification to the Tennessee Higher Education Commission (THEC) to develop a Master of Athletic Training (MAT) program. The proposed program will be housed in the Department of Health and Human Performance within the College of Behavioral and Health Sciences.

Student affairs committee

- Catherine Evans Harvill building is under construction to become the new dining hall.
 - New dining hall scheduled to open Fall 2024
- Morgan University Center Caf will be under phased construction to become a new expanded food court with national brands.
 - Phased construction 2023 – 2025
 - New food court scheduled to open Fall 2025

DINING SERVICES RENOVATIONS

Food Hall Project at Catherine Evans Harvill – Fall 2024 Opening



**THE
FOOD
HALL**

DINING SERVICES RENOVATIONS

Food Hall Project at Catherine Evans Harvill – Fall 2024 Opening

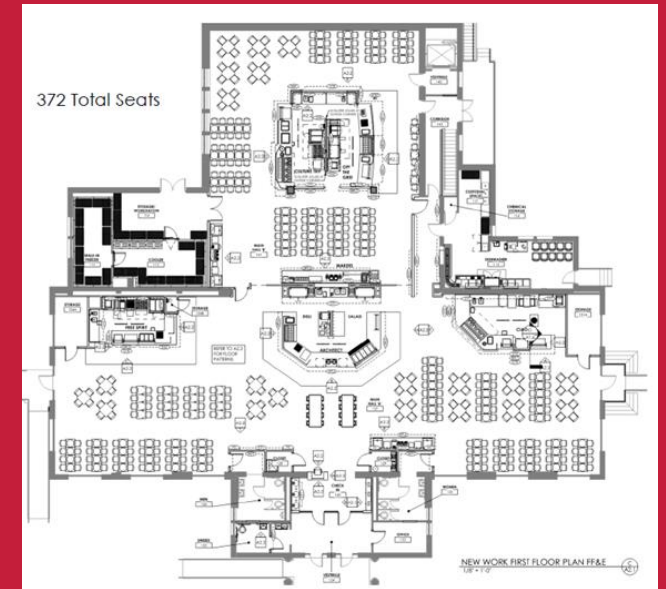

DINING SERVICES RENOVATIONS

New Food Court expansion in Morgan University Center– Fall 2025 opening



Campus Spotlight: The College of Graduate Studies



AP Austin Peay
State University
CLARKSVILLE  TENNESSEE

Dr. Chad Brooks
Vice Provost & Dean, College of Graduate Studies
Professor, Department of Biology

O'Malley Family Welcome Center



The APSU Campus Master Planning Process

Dober Lidsky Mathey

STEP 1

Planning Assumptions

Vision & Planning Assumptions

STEP 2

*Existing Situation
3 Studies*

Programs
Curriculum
Pedagogy

Building & Space
Assessment

Campus & Environs
Assessment

STEP 3

Findings, Needs, & Potential Projects

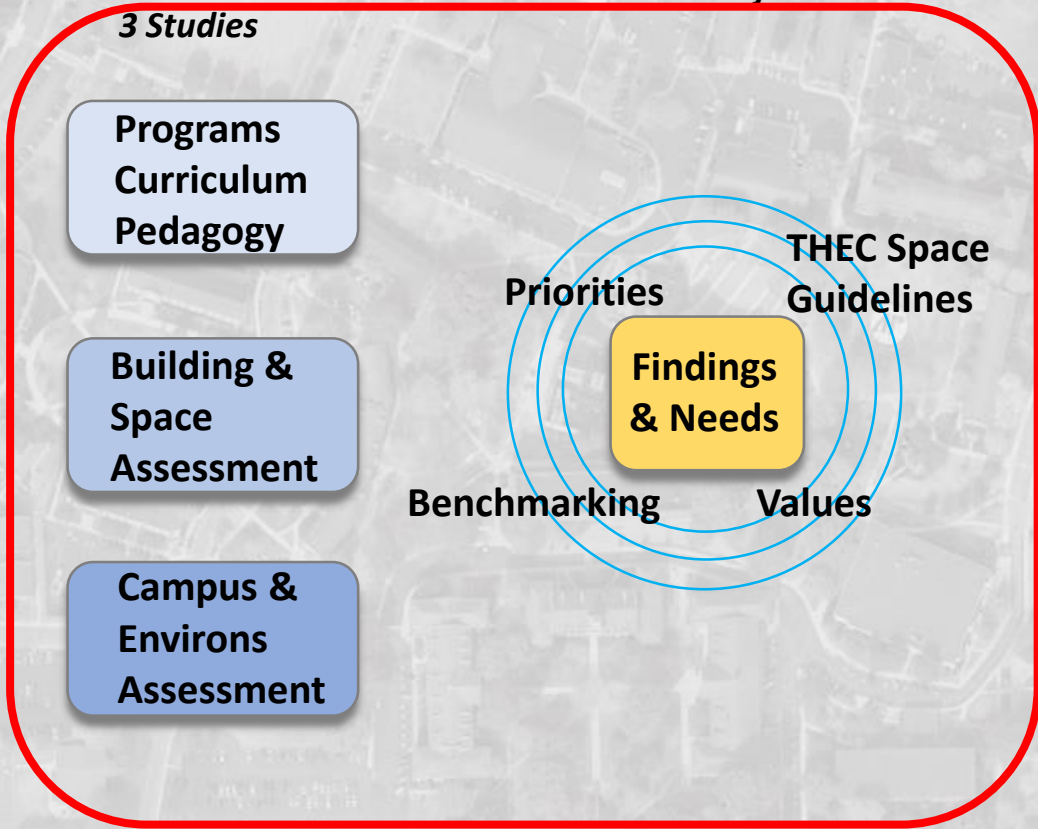

STEP 4

Alternatives to Address Needs

BUILDINGS

Renovation
New Construction



CAMPUS

Roads, Parking
Open Space, Landscape
Playfields
Property
Financial Implications

STEP 5

Campus Plan

APSU Campus Plan

Multidisciplinary Academic Building



Sports Broadcasting

College of Arts & Letters

Culinary Arts

Reserve Officer Training Corps

College of Behavioral & Health Sciences

**Institute for National Security
& Military Studies**



Strategic Plan Update

- June 10, 2022 – APSU Board of Trustees approves the new APSU Strategic Plan
- June-December 2022 – Tactical plans are finalized
- July 2022 – SLT defined WIGs
- February 2023 – Tactics are approved
- February 2023 – SLT votes to provide funding to support WIGs



Key Wildly Important Goals (WIGs)

University leadership selected three WIGs for the strategic plan's first year, and will continue focusing on them during the 2023-2024 strategic planning cycle:

- **Pillar 2, Goal 2:** Equip students to pursue educational and career goals in an empowering environment
- **Pillar 4, Goal 2:** Increase community involvement through robust and unique programming
- **Pillar 3, Goal 2:** Support a campus culture where all employees can grow and flourish



Funding the Plan

2023/2024 Strategic Plan - Year 1	
P1G2 - GO Band Scholarship	\$44,000
P1G2 - Marketing Budget	\$150,000
P1G2 - CRM Upgrade	\$100,000
P2G2 - Day of Service	\$15,000
P4G2 - Community Open House	\$20,000
P4G2 - Leadership Exchange	\$3,000
P4G2 - Partnership Promotion & Data	\$5,000
P4G2 - Master Calendar	\$6,000
P4G2 - Implement Athletics Plan Initiatives	\$20,000